

**NOTICE OF PUBLIC HEARING – HEARING EXAMINER  
SHORELINE SUBSTANTIAL DEVELOPMENT PERMIT (SSDP) / SEPA NOTIFICATION  
FILE NO.: SSDP2019-00190– Parkinson Dock**

**When:** September 27, 2019 at 1:00 p.m.

**Location of Hearing:** City Hall Council Chambers, 801 228<sup>th</sup> Avenue SE, Sammamish, WA

**Date of Notice:** August 28, 2019

**PROJECT DESCRIPTION:** Shoreline Substantial Development Permit (SSDP) to allow the construction of a new 62-foot long, private dock for a single-family residential property on Beaver Lake, in the R-4 Zoning District.

**SEPA THRESHOLD DETERMINATION:** Issuance of a Determination of Non-Significance (DNS)

**ACTIONS INCLUDED:** Recommendation to Hearing Examiner on an SSDP (Type 4 - Hearing Examiner)  
SEPA Threshold DNS (Type 2 – Director Decision)

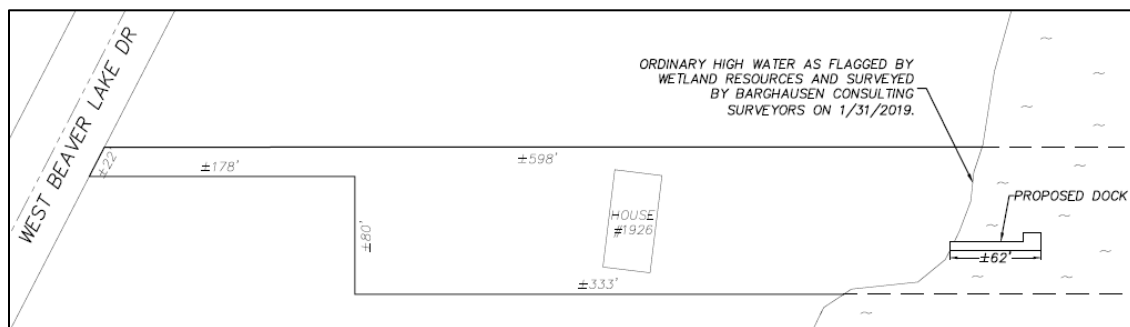

**Project Location:** 1926 W. Beaver Lake Drive SE (Parcel No.: 0224069042)

**Applicant/Owner:** Stephen Parkinson, 1926 W. Beaver Lake Drive SE, Sammamish, WA

**Online Documents:** <https://spaces.hightail.com/space/EjNSYrcOtn>

**Environmental Documents:** Dock design/plans, JARPA form, and SEPA checklist

**Staff Member Assigned:** Avril Baty, AICP, Principal Planner, [abaty@sammamish.us](mailto:abaty@sammamish.us), (425) 295-0627

**Appeal Process:** There is no appeal of this Notice of Public Hearing and Staff Recommendation. In accordance with SMC 20.10.240, the City of Sammamish Hearing Examiner is required to issue a decision within 10 days of the conclusion of the hearing. The Hearing Examiner's Decision on this SSDP shall be considered the final decision of the City and is subject to request for reconsideration under SMC 20.10.260 and in accordance with City of Sammamish Hearing Examiner Rules of Procedure Section 504. The final decision of the City, as issued by the City of Sammamish Hearing Examiner, is appealable to the Washington State Shoreline Hearings Board in accordance with RCW 90.58.180 and SMC 25.08.090.

**SEPA Appeal Deadline:** Per SMC 20.10.080 and 20.15.130, appeal of a Type 2 Decision must be submitted in writing with the appropriate filing fee (\$250.00) and received by 5:00 p.m. on the last day of the appeal period at City Hall, located at 801 228th Ave SE, Sammamish, WA, 98075. Appeal instructions are available at City Hall, or are available upon request at 425.295.0500. **Appeal of the Project SEPA DNS must be received at the address above by September 18, 2019 at 5:00 p.m. per SMC 20.15.130.**

*Inquiries regarding the application, revised decision, and appeal process, as well as requests to view documents pertinent to the proposal, may be made at the City of Sammamish City Hall, 801 228th Avenue SE, Sammamish, Washington 98075, (Tel: 425.295.0500) during normal business hours, Monday through Friday, 8:30 a.m. to 5:00 p.m. Mediation of disputes is available pursuant to SMC 20.20. Requests for mediation should be made as soon as it is determined the disputed issue(s) cannot be resolved by direct negotiation. Please contact the Department of Community Development for additional information on the Land Use Mediation Program.*